

Floor Plan

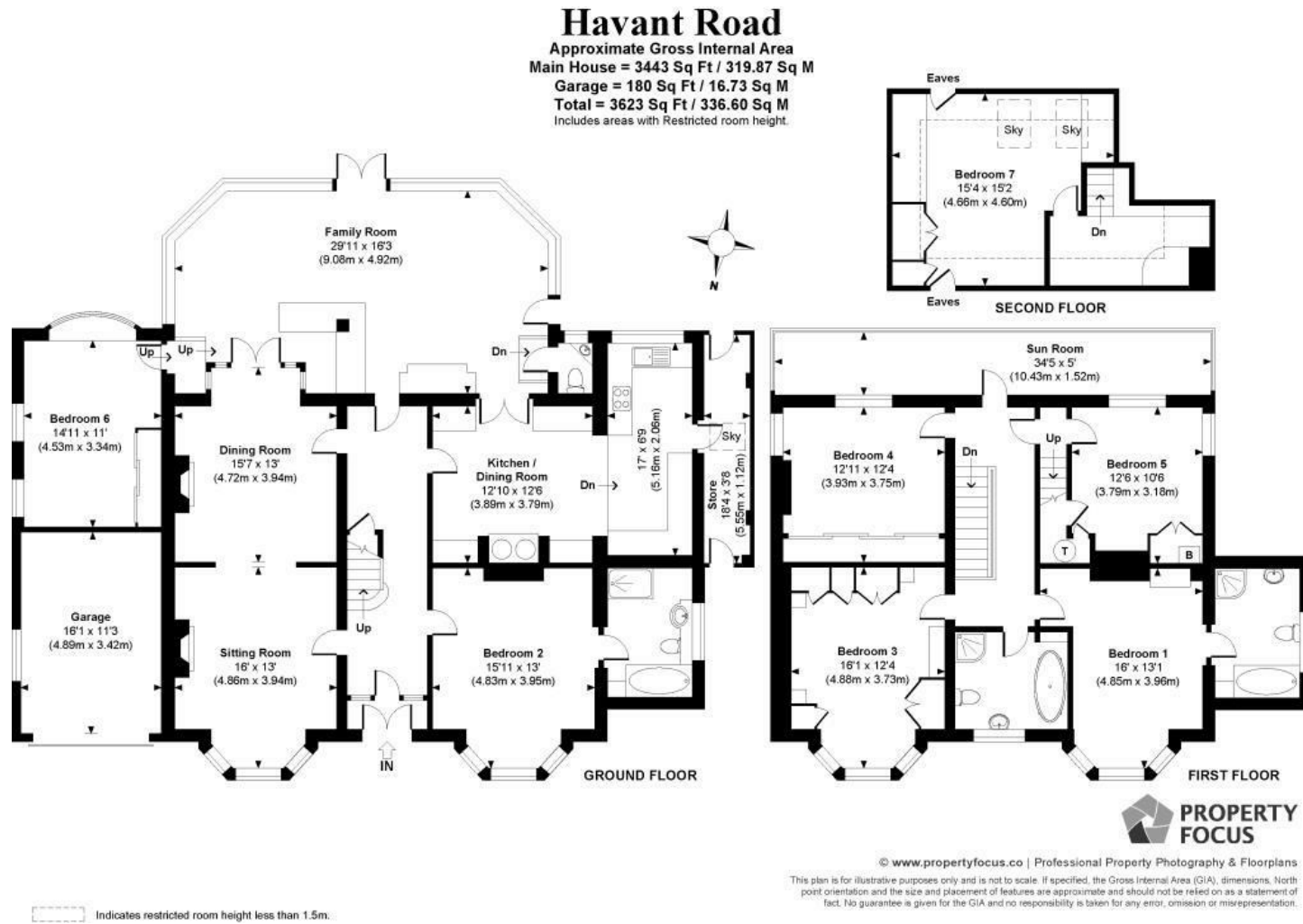

340 Havant Road
Portsmouth, PO6 1PQ

Castles are pleased to welcome to the market this substantial seven bedroom detached character property in the popular location of Havant Road, Drayton.

The ground floor consists of three reception rooms, one bedroom with en-suite, kitchen/ diner and utility. To the first floor there are four bedrooms, two bathrooms and a first floor sunroom with views across the south facing garden. There is a further guest suite to the second floor.

Externally there is a drive in drive out driveway with a garage and further parking for numerous cars to the back.

This property boasts stunning period features, high ceilings, large bay windows and is offered with no chain.

Another bonus with this home is you are in the catchment for Court Lane, Solent and Springfield Schools.

It is also a short walk to the local shops of Drayton and has great access to motorway links.

Offers over £600,000

These particulars, whilst believed to be accurate are set out as a general outline only for guidance and do not constitute any part of an offer or contract. Intending purchasers should not rely on them as statements of representation of fact, but must satisfy themselves by inspection or otherwise as to their accuracy. No person in this firm's employment has the authority to make or give any representation or warranty in respect of the property.

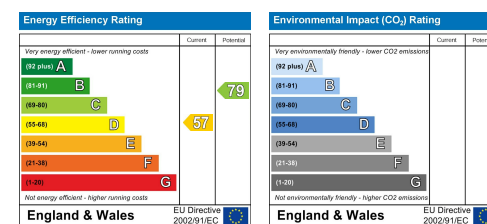

DIRECTORS

CHARLES TUSON • GARY AGAR • SEAN WREN

1 CASTLE STREET
PORTCHESTER
PO16 9QD



02394318899



CHARLES@CASTLESTATES.CO.UK
GARY@CASTLESTATES.CO.UK
SEAN@CASTLESTATES.CO.UK

COMPANY NUMBER: 12821075 • VAT NUMBER: 356389459

340 Havant Road

Portsmouth, PO6 1PQ



- SEVEN BEDROOMS
- DRAYTON
- PERIOD FEATURES
- SOUTH FACING GARDEN
- DETACHED
- THREE BATHROOMS
- NO FORWARD CHAIN
- LARGE FAMILY HOME

SITTING ROOM

16 x 13 (4.88m x 3.96m)

DINING ROOM

49'2" x 22'11" x 42'7" (15'7 x 13)

FAMILY ROOM

29'11 x 16'3 (9.12m x 4.95m)

KITCHEN

12'10 x 12'6 (3.91m x 3.81m)

GARAGE

16'1 x 11'3 (4.90m x 3.43m)

BEDROOM ONE

16 x 3'1 (4.88m x 0.94m)

BEDROOM TWO

15'11 x 13 (4.85m x 3.96m)

BEDROOM THREE

16'1 x 12'4 (4.90m x 3.76m)

BEDROOM FOUR

12'11 x 12'4 (3.94m x 3.76m)

BEDROOM FIVE

12'6 x 10'6 (3.81m x 3.20m)

BEDROOM SIX

14'11 x 11 (4.55m x 3.35m)

BEDROOM SEVEN

15'4 x 15'2 (4.67m x 4.62m)

Solicitors

If you are looking for a solicitor to handle the conveyancing process

then do let us know as we can point you in the direction of some local, well recommended companies that would be happy to help and provide you with a quote.

Financial Services

If you are looking to get a comparison on your mortgage deal then do let us know as we can put you in touch with some independent mortgage advisors that would be happy to help. It is always worth a last minute comparison before you purchase a property as the current deals can change weekly.

